

19th Annual

JANZEN RANCHES



Red Simmental



& Red Angus Bull Sale

Thursday, 2:00 p.m.

February 16, 2012

on the ranch, Rosemary, AB

Simmental bulls average \$4218.00

Angus bulls average \$3938.00

Welcome

Hold onto the tail and she'll pull you through.

Wow, hope this trend stays a few years! With heavy steer calves dollaring out over a thousand dollars, now would be a good time to get some performance in your next calf crop and at our place we try to do that without sacrificing calving ease. With last year's never-ending winter, calving would have been a lot more work if we had to assist cows at birth. The cows had a great grass year with good spring rains. The little bit of farm land we have was, well, the white combine took care of that.

There are a couple new sire groups that we feel should be good for any direction you need to go with your cows. Please feel free to come anytime prior to the sale, phone us or any of the sale staff. Remember the sale will start at 2:00 PM and the bulls will be outside and Sandy will be there with chili and a bun for lunch.



Matt and Andrew Janzen

JANZEN
RANCHES

Andrew & Donna 403/378-4690

Andrew cell: 403/376-0499

Matt & Marianne 403/378-3788

Matt cell: 403/793-1146

Matt email: mjanzen@eidnet.org

Box 264, Rosemary T0J 2W0

Auctioneer:

Don Oberg 780/678-6926

Special Representatives:

Dennis Ericson 780/361-9347

Darryl Snider 403/803-6532

Rod McLean 403/793-3060

Lowell Johnston 403/820-0516

Payment Terms:

Full payment on sale day, OR ½ purchase sale day with the balance due May 1st.

**Take your purchase home sale day
and receive \$50 off!**

Delivery

Free delivery of bulls at the purchaser's risk to points within a 350 mile radius of Rosemary. Delivery beyond the 350 mile radius will be at cost. Delivery will start April 15. Bulls may be kept at Janzen's free of charge until delivery. Should the purchaser wish to extend the bull's stay beyond this date, the cost of feed and care will be \$3.00/day/bull. Each bull becomes the buyer's risk when sold. Insurance will be available at the sale and should be purchased for bulls left at Janzen Ranches for feed and care.

Semen Testing

All bulls will be measured and palpated by our vet. With the bulls not being over a year off age, we will test the bulls in the warm weather, around the end of March.

Sale headquarters:

Heritage Inn, Brooks 1-888-888-4374

Join us for pre-sale lunch at 11:00.

Sale day phones:

Jay Good 403/556-5563 Bob Wilson 403/540-3084

Glenn Norton 780/542-0634 Darren Paget 403/323-3985

Matt Janzen cell: 403/793-1146

Terms & Conditions

The sale will be conducted under the standard Transcon Livestock Corp. Terms and Conditions. Copies will be available at the settlement desk.

The EPDs in the catalog are in the following format:

Simmental EPDs:

CE BW WW YW MCE MWWT Milk

Red Angus EPDs:

BW WW YW Milk TM CE MCE

Catalog production by Jamesway Catalogs 403 938-8145

email: transcon@transconlivestock.com
www.transconlivestock.com
Transcon Livestock Corp.
403/638-9377 Fax: 403/206-7786
Box 300, Sundre, AB T0M 1X0
JG cell: 403/556-5563 BW cell: 403/540-3084
GN cell: 780/542-0634 SM cell: 403/363-9973
DP cell: 403/323-3985



Beech Bros Shenanigan HHS



Beech Bros Utilizer 414U



X-T Tabasco 20T



IPU Red Bodybuilder 62S

Sales Management Comments

The biggest testament to a registered cattle breeder is to establish a repeat customer base. When your customers spend their hard earned money on your product, and repeatedly return to do it again and again, it completely validates your objectives as a livelihood choice. Janzen Ranches possess one of the best repeat customer followings as any breeding unit we offer our complete sale management services to. Not only is the customer base satisfied enough to return time and time again but many buy in volume too. Producers are able to satisfy multiple purchases with the availability of large sire groups made from the exclusive Janzen Ranches' herdbull battery.

The "soundness" of the Janzen bulls would also of course be a large reason for the satisfied loyalists. The foot quality always annually impresses me very much. It is nice to know you don't have to screen for structure in the Janzen bulls. Additionally, these bulls are the final sort created from 300 mother cows.

We hope to see you at the ranch sale day, but if you can't make it, feel free to give us a call to assist you with your purchasing needs.

For the Janzen families,

Jay Good,
Transcon Livestock Corp.

Transcon on order:

Lot 1 \$4900.00 C Bar K Simmentals Carstairs, AB



Jay Good
403/556-5563



Sandra Smith
403/638-9377



Kelly Richardson
403/638-9377



Glenn Norton
780 542-0634



Bob Wilson
403/540-3084



Shane Michelson
403/363-9973



Darren Paget
403/323-3985



Remington Specialist 32W



TBSF Washington 67W



\$4900.00

AEDJ SPECIALIST 3Y

POLLED PUREBRED MALE

PG753204

AEDJ 3Y

26 January 2011

IPU RED SPECIALIST 70T

REMINGTON STING 11R

REMINGTON SPECIALIST 32W

AEDJ MS STING 47W

PG718269

PG733390

REMINGTON SOFT TOUCH 4S

AEDJ MS RED COPPER 6P

BW: 75. 205 day: 731. 365 day: 1315. ADG: 3.7. WPDA: 3.4.

EPDs Spring 2012: 8.5 0.5 30.4 53.9 5.0 21.3 6.0

Quad Polled/Quad Red.



\$4800.00

AEDJ SPECIALIST 9Y

POLLED PUREBRED MALE

PG753205

AEDJ 9Y

3 February 2011

IPU RED SPECIALIST 70T

BEECHBROSHENANIGAN11S

REMINGTON SPECIALIST 32W

AEDJ MS NOPHALT 178W

PG718269

PG733402

REMINGTON SOFT TOUCH 4S

AEDJ MS PEPPER 73P

BW: 92. 205 day: 726. 365 day: 1336. ADG: 3.8. WPDA: 3.4.

EPDs Spring 2012: 7.0 2.4 36.8 66.1 5.0 21.3 2.9

Quad Polled/Quad Red.

AEDJ SPECIALIST 10Y

POLLED PUREBRED MALE

PG753251

AEDJ 10Y

3 February 2011

IPU RED SPECIALIST 70T

SUNSTAR PRIMEOBJECTIVE45P

REMINGTON SPECIALIST 32W

AEDJ MS PRIME 108U

PG718269

PG753014

REMINGTON SOFT TOUCH 4S

AEDJ MS RED COPPER 14P

BW: 90. 205 day: 637. 365 day: 1135. ADG: 3.1. WPDA: 3.0.

EPDs Spring 2012: 6.0 2.4 32.8 57.4 5.7 20.8 4.4

Quad Polled/Quad Red.



\$3300.00



\$4400.00

8

AEDJ TACO 48Y

POLLED PUREBRED MALE
PG753209

AEDJ 48Y

21 February 2011

D BAR C REGENCY 23R
X-T TABASCO 20T
PG676686
X-T MISS UPTOWN 26R

REMINGTON STING 11R
AEDJ MS STING 98T
PG693065
AEDJ MS COUNTRY 5M

BW: 85. 205 day: 789. 365 day: 1352. ADG: 3.5. WPDA: 3.7.
EPDs Spring 2012: 8.3 0.8 35.1 65.4 6.1 24.6 7.0
Triple Polled/Triple Red.



\$4300.00

9

AEDJ UT 51Y

POLLED PUREBRED MALE
PG753210

AEDJ 51Y

22 February 2011

MRL TALLADEGA 15S
BEECH BROS UTILIZER 414U
PG703920
TWIN-CHIEF PUNCH 414P

REMINGTON STING 11R
AEDJ MS STING 19U
PG715451
AEDJ MS COPPER 3S

BW: 90. 205 day: 853. 365 day: 1344. ADG: 3.1. WPDA: 3.7.
EPDs Spring 2012: 6.8 1.6 34.4 61.9 5.3 22.2 5.0
Quad Polled/Quad Red.



\$4000.00

10

AEDJ TACO 56Y

POLLED PUREBRED MALE
PG753211

AEDJ 56Y

23 February 2011

D BAR C REGENCY 23R
X-T TABASCO 20T
PG676686
X-T MISS UPTOWN 26R

SUNSTAR PRIMEOBJECTIVE45P
AEDJ MS PRIME 96S
PG680547
AEDJ MS PEPPER 85L

BW: 98. 205 day: 711. 365 day: 1268. ADG: 3.5. WPDA: 3.5.
EPDs Spring 2012: 6.3 2.3 35.6 61.7 21.7 3.8
Triple Polled/Triple Red.



\$3300.00

11

AEDJ BODYBUILDER 60Y

POLLED PUREBRED MALE
PG753212

AEDJ 60Y

24 February 2011

LCHMN BODYBUILDER 7303F
IPU RED BODYBUILDER 62S
PG663830
IPU RED MS SHAMROCK 162N

BAR 15 COPPER 21M
AEDJ MS COPPER 6R
PG644413
AEDJ MS PEPPER 11N

BW: 92. 205 day: 699. 365 day: 1277. ADG: 3.6. WPDA: 3.5.
EPDs Spring 2012: 7.0 1.3 30.4 58.3 4.2 21.2 6.0
Quad Polled/Quad Red.

AEDJ TACO 65Y

POLLED PUREBRED MALE
PG753213

AEDJ 65Y

26 February 2011

D BAR C REGENCY 23R
X-T TABASCO 20T
PG676686
X-T MISS UPTOWN 26R

SVS M906
AEDJ MS STARLIGHT 67P
PG646026
AEDJ MS IRISH 12K

BW: 95. 205 day: 733. 365 day: 1349. ADG: 3.9. WPDA: 3.7.
EPDs Spring 2012: 7.5 1.6 35.3 62.6 6.2 21.9 3.3
Triple Polled/Triple Red.



\$6700.00

12



\$4200.00

13

AEDJ TACO 73Y

POLLED PUREBRED MALE
 PG753214 AEDJ 73Y 27 February 2011
 D BAR C REGENCY 23R SUNSTAR PRIMEOBJECTIVE45P
 X-T TABASCO 20T AEDJ MS PRIME 172S
 PG676686 PG680563
 X-T MISS UPTOWN 26R AEDJ MS PREMIER 81J

BW: 90. 205 day: 805. 365 day: 1296. ADG: 3.0. WPDA: 3.6.
 EPDs Spring 2012: 4.8 3.1 36.8 63.1 5.8 23.9
 Double Polled/Double Red.



\$5800.00

14

JJJS BODYBUILDER 74Y

POLLED PUREBRED MALE
 PG753192 JJJS 74Y 27 February 2011
 LCHMN BODYBUILDER 7303F SV KOOL DN K918
 IPU RED BODYBUILDER 62S 7P NADIA 10N
 PG663830 G624939
 IPU RED MS SHAMROCK 162N MISS PREMIER SENSATION10C

BW: 97. 205 day: 833. 365 day: 1358. ADG: 3.3. WPDA: 3.8.
 EPDs Spring 2012: 6.0 2.0 36.3 70.5 4.2 26.3 8.2
 Double Polled/Double Red.



\$5100.00

15

JJJS BODYBUILDER 76Y

POLLED PUREBRED MALE
 PG753194 JJJS 76Y 28 February 2011
 LCHMN BODYBUILDER 7303F SV KOOL DN K918
 IPU RED BODYBUILDER 62S 7P MARCIA 5M
 PG663830 PG591595
 IPU RED MS SHAMROCK 162N SSP FERGY 20D

BW: 102. 205 day: 901. 365 day: 1426. ADG: 3.3. WPDA: 3.9.
 EPDs Spring 2012: 5.3 2.8 37.6 70.3 4.8 26.0 7.2
 Double Polled/Double Red.



\$3600.00

16

AEDJ LABEL 80Y

POLLED PUREBRED MALE
 PG753215 AEDJ 80Y 28 February 2011
 REMINGTON RED LABEL HR BAR 15 COPPER 21M
 JJJS RED LABEL 9T AEDJ MS COPPER 8R
 PG682707 PG644415
 JJJS RED ZIMA 7R AEDJ MS PEPPER 36N

BW: 92. 205 day: 701. 365 day: 1298. ADG: 3.7. WPDA: 3.6.
 EPDs Spring 2012: 6.5 1.7 31.2 52.4 4.9 18.6 3.0
 Triple Polled/Triple Red.

JJJS UT 87Y

POLLED PUREBRED MALE
 PG753195 JJJS 87Y 3 March 2011
 MRL TALLADEGA 15S SVS M906
 BEECH BROS UTILIZER 414U JJJS MS RED LITE 130U
 PG703920 PG715443
 TWIN-CHIEF PUNCH 414P MAJS LA CALF 12L

BW: 89. 205 day: 759. 365 day: 1330. ADG: 3.6. WPDA: 3.6.
 EPDs Spring 2012: 6.8 1.9 34.4 59.1 5.8 17.5 0.3
 Quad Polled/Quad Red.



\$3800.00

17



AEDJ LABEL 89Y

POLLED PUREBRED MALE
PG753217

AEDJ 89Y

3 March 2011

REMINGTON RED LABEL HR
JJJS RED LABEL 9T
PG682707
JJJS RED ZIMA 7R

SVS M906
AEDJ MS STARLIGHT 57P
PG647555
AEDJ ROMEO 4L

BW: 98. 205 day: 793. 365 day: 1337. ADG: 3.4. WPDA: 3.7.
EPDs Spring 2012: 5.8 2.2 36.7 61.0 4.6 22.1 3.7
Double Polled/Triple Red.



AEDJ WASH 105Y

SCURRED PUREBRED MALE
SG753218

AEDJ 105Y

6 March 2011

TBSF SAMUEL 29S
TBSF WASHINGTON 67W
PG717338
TBSF PHOEBE 36P

BAR 15 COPPER 21M
AEDJ MS COPPER 110P
PG646038
AEDJ MS ROMEO 74J

BW: 105. 205 day: 882. 365 day: 1453. ADG: 3.6. WPDA: 4.0.
EPDs Spring 2012: 4.8 3.2 42.0 65.8 4.1 29.0 8.0
Triple Polled/Scurred/Triple Red.



AEDJ LABEL 106Y

POLLED PUREBRED MALE
PG753220

AEDJ 106Y

6 March 2011

REMINGTON RED LABEL HR
JJJS RED LABEL 9T
PG682707
JJJS RED ZIMA 7R

BAR 15 COPPER 21M
AEDJ COPPER MS 3R
PG644410
AEDJ MS SHAMROCK 54N

BW: 95. 205 day: 798. 365 day: 1355. ADG: 3.5. WPDA: 3.8.
EPDs Spring 2012: 6.8 1.4 30.3 49.9 4.8 21.3 6.1
Quad Polled/Quad Red.



AEDJ TACO 110Y

POLLED PUREBRED MALE
PG753222

AEDJ 110Y

8 March 2011

D BAR C REGENCY 23R
X-T TABASCO 20T
PG676686
X-T MISS UPTOWN 26R

BAR 15 COPPER 21M
SLJS MS COPPER 1R
PG647243
SLJS MS BELL 1M

BW: 98. 205 day: 738. 365 day: 1316. ADG: 3.6. WPDA: 3.6.
EPDs Spring 2012: 7.3 2.1 36.5 66.7 5.6 26.0 7.8
Triple Polled/Triple Red.

JJJS LABEL 118Y

POLLED PUREBRED MALE
PG753197

JJJS 118Y

9 March 2011

REMINGTON RED LABEL HR
JJJS RED LABEL 9T
PG682707
JJJS RED ZIMA 7R

KS GO FIGURE M799
7P POLLY 15P
PG644522
CG RED GINA 226M

BW: 90. 205 day: 726. 365 day: 1283. ADG: 3.5. WPDA: 3.6.
EPDs Spring 2012: 7.5 1.7 39.1 61.2 3.9 21.7 2.2
Quad Polled/Quad Red.





\$4250.00

23

AEDJ TACO 128Y

POLLED PUREBRED MALE
 PG753224 AEDJ 128Y 12 March 2011
 D BAR C REGENCY 23R SV KOOL DN K918
 X-T TABASCO 20T AEDJ MS KOOL 92S
 PG676686 PG680544
 X-T MISS UPTOWN 26R AEDJ MS CISCO 57L

BW: 90. 205 day: 805. 365 day: 1323. ADG: 3.2. WPDA: 3.7.
 EPDs Spring 2012: 7.0 1.9 35.6 67.6 7.2 23.6 5.8
 Triple Polled/Triple Red.



\$3300.00

24

AEDJ TACO 131Y

POLLED PUREBRED MALE
 PG753225 AEDJ 131Y 13 March 2011
 D BAR C REGENCY 23R LBR RED BEACON L405
 X-T TABASCO 20T AEDJ MS BEACON 48R
 PG676686 PG644448
 X-T MISS UPTOWN 26R AEDJ MS PEPPER 42M

BW: 100. 205 day: 733. 365 day: 1336. ADG: 3.7. WPDA: 3.7.
 EPDs Spring 2012: 6.8 2.0 34.5 61.8 6.1 21.2 3.9
 Triple Polled/Triple Red.



\$2800.00

25

AEDJ LABEL 137Y

SCURRED PUREBRED MALE
 SG753226 AEDJ 137Y 14 March 2011
 REMINGTON RED LABEL HR SPRING VALLEY G922
 JJJS RED LABEL 9T AEDJ PEARL 51K
 PG682707 G545308
 JJJS RED ZIMA 7R AEDJ MS INHERITOR 14F

BW: 102. 205 day: 725. 365 day: 1322. ADG: 3.7. WPDA: 3.6.
 EPDs Spring 2012: 5.0 2.6 35.0 59.0 5.4 25.4 7.9
 Double Polled/Scurred/Double Red.



\$5300.00

26

AEDJ NOPHALT 139Y

POLLED PUREBRED MALE
 PG753227 AEDJ 139Y 14 March 2011
 PPSR NOPHALT 20H IPU RED BODACIOUS 104H
 BEECH BRO SHENANIGAN 11S RPP MS BO 318N
 PG665065 PG621798
 BEECH BRO PIXXY 95P CSS BLEU PARFAIT 11G

BW: 90. 205 day: 851. 365 day: 1329. ADG: 3.0. WPDA: 3.7.
 EPDs Spring 2012: 7.0 3.2 42.0 76.0 3.9 22.8 1.8
 Triple Polled/Double Red.

AEDJ TACO 144Y

POLLED PUREBRED MALE
 PG753228 AEDJ 144Y 15 March 2011
 D BAR C REGENCY 23R DOUBLE BAR D RED LP 66R
 X-T TABASCO 20T AEDJ MS RED LP 92T
 PG676686 PG733549
 X-T MISS UPTOWN 26R AEDJ MS RED LIGHT 86R

BW: 95. 205 day: 746. 365 day: 1317. ADG: 3.6. WPDA: 3.6.
 EPDs Spring 2012: 6.3 2.4 31.5 54.5 6.1 17.8 2.1
 Triple Polled/Triple Red.



\$3500.00

27



Out

28

AEDJ LABEL 146Y

POLLED PUREBRED MALE

AEDJ 146Y

17 March 2011

REMINGTON RED LABEL HR
 JJJS RED LABEL 9T
 PG682707
 JJJS RED ZIMA 7R

PARKWOOD MR. NAMELY 60N
 SJLS MS BIG COUNTRY 6R
 PG647248
 AEDJ MISS PREMIER 35D

BW: 104. 205 day: 848. 365 day: 1411. ADG: 3.5. WPDA: 3.9.
 EPDs Spring 2012: 6.5 1.8 33.6 59.1 4.9 22.2 5.3
 Double Polled/Double Red.



\$5000.00

29

AEDJ NOPHALT 151Y

POLLED PUREBRED MALE
 PG753233

AEDJ 151Y

20 March 2011

PPSR NOPHALT 20H	BAR 15 COPPER 21M
BEECH BRO SHENANIGAN 11S	AEDJ MS COPPER 91P
PG665065	PG646037
BEECH BRO PIXXY 95P	AEDJ PEARL 51K

BW: 100. 205 day: 838. 365 day: 1401. ADG: 3.5. WPDA: 3.9.
 EPDs Spring 2012: 7.0 2.7 36.7 70.0 4.4 23.4 5.0 0.20
 Triple Polled/Triple Red.



30

\$4400.00

AEDJ LABEL 155Y

POLLED PUREBRED MALE
 PG753234

AEDJ 155Y

21 March 2011

REMINGTON RED LABEL HR	BAR 15 COPPER 21M
JJJS RED LABEL 9T	AEDJ MS RED COPPER 9P
PG682707	PG647551
JJJS RED ZIMA 7R	AEDJ MS ROMEO 94M

BW: 100. 205 day: 879. 365 day: 1357. ADG: 3.4. WPDA: 3.8.
 EPDs Spring 2012: 5.3 2.4 31.4 53.7 4.8 22.2 6.5
 Triple Polled/Triple Red.

JJJS LABEL 158Y

POLLED PUREBRED MALE
 PG753199

JJJS 158Y

22 March 2011

REMINGTON RED LABEL HR	REMINGTON STING 11R
JJJS RED LABEL 9T	JJJS MS STING 136T
PG682707	PG693049
JJJS RED ZIMA 7R	JJJS MS MARIPOSA 2M

BW: 102. 205 day: 776. 365 day: 1264. ADG: 3.1. WPDA: 3.5.
 EPDs Spring 2012: 7.0 1.2 34.9 57.4 4.2 22.3 4.8
 Triple Polled/Triple Red.



31

\$3300.00



\$5600.00

37

AEDJ NOPHALT 175Y

POLLED PUREBRED MALE TWIN 29 March 2011
 PG753241 AEDJ 175Y

PPSR NOPHALT 20H REMINGTON STING 11R
 BEECH BRO SHENANIGAN 11S AEDJ MS STING 18U
 PG665065 PG715452
 BEECH BRO PIXXY 95P AEDJ MS BEACON 28S

BW: 55. 205 day: 911. 365 day: 1436. ADG: 3.3. WPDA: 3.8.
 EPDs Spring 2012: 7.3 2.3 40.3 74.4 3.8 23.3 3.1
 Quad Polled/Quad Red.



\$2800.00

38

TJJS LABEL 190Y

POLLED PUREBRED MALE TJJS 190Y 3 April 2011
 PG753173
 REMINGTON RED LABEL HR BAR 15 COPPER 21M
 JJJS RED LABEL 9T TJJS MS COPPER 2R
 PG682707 PG647250
 JJJS RED ZIMA 7R TJJS MS RED PREMIER 3N

BW: 98. 205 day: 840. 365 day: 1385. ADG: 3.2. WPDA: 3.8.
 EPDs Spring 2012: 6.0 2.0 30.9 52.3 5.2 22.4 6.9
 Triple Polled/Triple Red.



39

\$3150.00

TJJS NOPHALT 191Y

POLLED PUREBRED MALE TJJS 191Y 3 April 2011
 PG753174
 PPSR NOPHALT 20H PROGRESSIVE ROUGH & READY
 BEECH BRO SHENANIGAN 11S TJJS MISS R+ R 19T
 PG665065 PG693090
 BEECH BRO PIXXY 95P TJJS MS COPPER 2R

BW: 98. 205 day: 843. 365 day: 1393. ADG: 3.5. WPDA: 3.9.
 EPDs Spring 2012: 6.0 3.4 37.5 71.2 4.4 22.9 4.1
 Triple Polled/Triple Red.

AEDJ LABEL 193Y

POLLED PUREBRED MALE AEDJ 193Y 3 April 2011
 PG753243
 REMINGTON RED LABEL HR BAR 15 COPPER 21M
 JJJS RED LABEL 9T AEDJ MS RED COPPER 12P
 PG682707 PG646035
 JJJS RED ZIMA 7R AEDJ MS COUNTRY 5M

BW: 100. 205 day: 986. 365 day: 1426. ADG: 2.8. WPDA: 3.9.
 EPDs Spring 2012: 7.3 1.3 33.6 59.1 4.6 23.5 6.7
 Quad Polled/Quad Red.



40

\$4000.00



\$3750.00

41

AEDJ WASH 199Y

POLLED PUREBRED MALE
 PG753244 AEDJ 199Y 10 April 2011
 TBSF SAMUEL 29S RJY MAXIMA 5M
 TBSF WASHINGTON 67W RAINALTA LASS 74R
 PG717338 PG657621
 TBSF PHOEBE 36P RAINALTA RED TOM 69J

BW: 98. 205 day: 920. 365 day: 1391. ADG: 3.6. WPDA: 3.9.
 EPDs Spring 2012: 4.0 3.8 41.0 63.3 4.9 24.2 3.7
 Triple Polled/Triple Red.



\$3750.00

42

JJJS TACO 206Y

POLLED PUREBRED MALE
 PG753202 JJJS 206Y 15 April 2011
 D BAR C REGENCY 23R LBR RED BEACON L405
 X-T TABASCO 20T JJJS 18P
 PG676686 PG618787
 X-T MISS UPTOWN 26R TESS MS RED STRAWBERRY

BW: 92. 205 day: 818. 365 day: 1349. ADG: 3.3. WPDA: 3.8.
 EPDs Spring 2012: 6.3 2.6 33.3 62.2 5.6 21.3 4.6
 Triple Polled/Triple Red.



\$4200.00

43

AEDJ SPECIALIST 230Y

POLLED PUREBRED MALE
 PG753249 AEDJ 230Y 30 April 2011
 IPU RED SPECIALIST 70T BAR 15 COPPER 21M
 REMINGTON SPECIALIST 32W AEDJ MS COPPER 65R
 PG718269 PG644464
 REMINGTON SOFT TOUCH 4S AEDJ MS RIGHT TIME 3K

BW: 88. 205 day: 834. 365 day: 1412. ADG: 3.6. WPDA: 3.9.
 EPDs Spring 2012: 8.8 1.0 28.3 51.7 5.8 21.1 7.0
 Triple Polled/Triple Red.



\$3900.00

44

AEDJ 90Y

RED ANGUS/SIMMENTAL MALE
 AEDJ 90Y 3 March 2011
 RED WEBR DOC HOLLIDAY 2N OSF REMINGTON STING 11R
 RED ML HOLIDAY 801U AEDJ MS STING 120T
 1482497 BPG693073
 RED DEER RANGE LEAH 805S AEDJ MS CISCO 57L

BW: 95. 205 day: 753. 365 day: 1290. WPDA: 3.7.

JJJS 115Y

SIMMENTAL/RED ANGUS MALE
 JJJS 115Y 9 March 2011
 REMINGTON RED LABEL HR RED BRYLOR STALLION 19J MAF
 JJJS RED LABEL 9T RED BROX ROSETTE 26N
 PG682707 1144434
 JJJS RED ZIMA 7R RED BROX ROSETTE 29G 899874
 BW: 102. 205 day: 731. 365 day: 1317. WPDA: 3.6.



\$3800.00

45



\$3800.00

50

RED JRA VECTOR 111Y

RED ANGUS MALE
1635190 JR 111Y 8 March 2011
RED TER-RON VECTOR 015R RED LCHMN RED SPREAD 1271F OSF MAF
RED SHODEREE VECTOR 98T RED SHODEREE QUIN 19R
1395379 1274455
RED SHODEREE GEMMIE 12J RED SHODEREE QUIN 8D
BW: 90. 205 day: 884. 365 day: 1391. ADG: 3.2. WPDA: 3.2.
EPDs Fall 2011 Red Angus: -0.8 30 63 13 27 5.5 5.0



\$3900.00

51

RED JRA VECTOR 117Y

RED ANGUS MALE
1635191 JR 117Y 9 March 2011
RED TER-RON VECTOR 015R RED CANYON CREEK SENSATION
RED SHODEREE VECTOR 98T RED JRA CRESTA 5R
1395379 1291054
RED SHODEREE GEMMIE 12J RED BROX CRESTA 23N
BW: 90. 205 day: 775. 365 day: 1315. ADG: 3.3. WPDA: 3.4.
EPDs Fall 2011 Red Angus: -0.4 23 45 9 21 5.5 2.5



\$3400.00

52

RED JRA VECTOR 129Y

RED ANGUS MALE
1635192 JR 129Y 12 March 2011
RED TER-RON VECTOR 015R RED SOO LINE LANCER 127M 11
RED SHODEREE VECTOR 98T RED SHODEREE DUCHESS 153R
1395379 1267425
RED SHODEREE GEMMIE 12J RED SHODEREE DUCHESS 106M
BW: 92. 205 day: 775. 365 day: 1288. ADG: 3.1. WPDA: 3.2.
EPDs Fall 2011 Red Angus: -0.1 23 46 9 20 5.5 4.0



\$3800.00

53

RED JRA VECTOR 181Y

RED ANGUS MALE
1635204 JR 181Y 31 March 2011
RED TER-RON VECTOR 015R RED FLYING K DYNAMITE 66L
RED SHODEREE VECTOR 98T RED SHODEREE ARDATH 143R
1395379 1264815
RED SHODEREE GEMMIE 12J RED SHODEREE ARDATH 217H
BW: 80. 205 day: 794. 365 day: 1414. ADG: 3.8. WPDA: 3.6.
EPDs Fall 2011 Red Angus: 1.5 36 65 9 27 2.0 4.0

Simmental bulls averaged \$4218.00 Red Angus bulls averaged \$3938.00

High Selling Simmental Bulls

- Lot 6 \$6800.00 Trevor Liboiron - Jennar, Ab
- Lot 12 \$6700.00 Battrum Cattle Co - Sibbald, Ab
- Lot 14 \$5800.00 7J Ranching Ltd - Seven Persons, Ab
- Lot 37 \$5600.00 Dale Stammers - Oyen, Ab
- Lot 7 \$5300.00 Battrum Cattle Co - Sibbald, Ab
- Lot 26 \$5300.00 Arvid Thompson - Milo, Ab
- Lot 15 \$5100.00 Rasmussen Farms - Orion, Ab

- Lot 34 \$5000.00 Morris Lupuliak - Chinook, Ab
- Lot 29 \$5000.00 Morris Lupuliak - Chinook, Ab

High Selling Red Angus Bulls

- Lot 48 \$5000.00 Chizik Holdings Ltd - Bassano, AB
- Lot 46 \$4600.00 Speargrass Cattle Co - Bassano, Ab

Volume Buyer:

Chizik Holdings Ltd Bassano Ab 3 lots at \$13,300.00



email:transcon@transconlivestock.com
www.transconlivestock.com
Transcon Livestock Corp.
403/638-9377 Fax: 403/206-7786
Box 300, Sundre, AB T0M 1X0
JG cell: 403/556-5563 BW cell: 403/540-3084
GN cell: 780/542-0634 SM cell: 403/363-9973
DP cell: 403/323-3985

RPS/REG

CANADA	POSTES
POST	CANADA
Postage paid	Port payé
Addressed Admail	Médiaposte avec adresse
#3486028	
RETURN POSTAGE GUARANTEED PORT DE RETOUR GARANTI	

Thank you to the buyers at our 2011 Sale:

Chizik Holdings Ltd., Ralph Chizik, Bassano, AB
Cronkhite Cattle Co. Ltd., Darcy Cronkhite, Warner, AB
Bar WR Simmentals, Carmen & Tracy Wright, Oyen, AB
Matthew & Adam Koester, Rockyford, AB
Rasmussen Farms, Duane & Janine Rasmussen, Orion, AB
O'Hara Farms Ltd., Todd O'Hara, Foremost, AB
Snake Valley Farms Ltd., Marvin or Al Vaage, Champion, AB
Milford Colony Farming Co. Ltd., Raymond, AB
Koester Cattle Co., Gordon Koester, Rockyford, AB
Wilson Ranch, Doug Wilson, Maple Creek, SK
Kasdorf Cattle Co. Ltd., Mark Kasdorf, Rosemary, AB
Conners Ranching Corp., Allan Conner, Patricia, AB
R & V White Ranch, Ross White, Jenner, AB
Newell Grazing Assoc., Scandia, AB
Clark & Sandra Ehnisz, Mendham, SK
Lyzenga Farms Ltd., Rosemary, AB
Ryan & Patricia Renke, Cypress County, AB
Speargrass Cattle Co. Ltd., Murray Jorgensen, Bassano, AB
Hoodoo Red Angus, Gene & Kelly Westwick, Patricia, AB
Viktor Petker, Rosemary, AB
Rick Strate, Magrath, AB
Carl Kern, Rosemary, AB
Arvid Thompson, Milo, AB
Jay Peterson, Barnwell, AB
Chris Schmidt, Rainier, AB
Fernando Dyck, Rosemary, AB
Trevor Liboiron, Jenner, AB
Randy Peterson, Barnwell, AB
Brad Osadcuk, Jenner, AB
Richard Mashon, Dorothy, AB
Murray McLean, Vulcan, AB
Lane Steiner, Arrowwood, AB
Marvin & Loretta Berg, Gem, AB
Bruce Christenson, Rainier, AB
Glen Dunbar, Twin Butte, AB

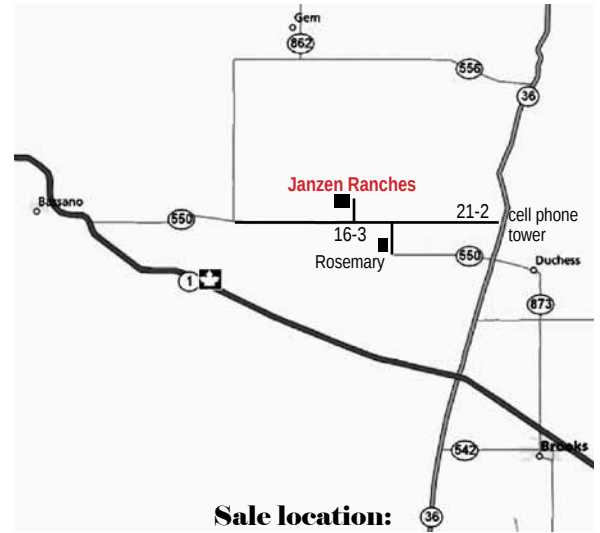

From #36 & Twp 21 Rd 2 (cell phone tower), go 9 miles West to Rg 16 Rd 3 and 1 mile North.

From the west take #550 to Rg 16 Rd 3 and 1 mile North.